

NEW WINDOWS

New grey uPVC window casements

Windows to provide opening area not less than 0.33m² with a minimum clear opening of 450x450mm

- To achieve a U-Value of 1.4W/(m².K)2 or better

NOTE: Window cill height matches existing first floor windows, opening lights to be discussed with Building Control as the cill height is below the 800mm height from FFL to avoid additional guarding

Anthracite half round grey uPVC guttering and downpipes

VELUX GGU PK08 ROOFLIGHT (RL-01 / RL-02 / RL-03)
Rooflight to be installed in accordance with Manufacturers requirements. Contractor to note the window installation is into a GRP pitched roof build up, therefore Velux should be consulted prior to the assumption the installation will follow that of an installation into a zinc roof covering. Timber rafters to be doubled up either side of roof light in accordance with SE requirements

GGU PK08 Velux rooflight, flashing kit to be discussed with Velux for use with GRP roof finish

15 Deg. GRP Pitched Roof with lead roll effect upstands

Roof Construction consisting of the following from inside to out:
- 12.5mm plasterboard with skim finish
- 175x50mm timber rafters
- 18mm OSB3
- Vapour Control Layer (VCL)
- 150mm PIR insulation board - Celotex XR4000
- 18mm OSB3 fixed back to rafters
- GRP roofing system with proprietary GRP lead rolls, dark grey finish

- To achieve a U-Value of 0.15W/(m².K)2 or better

Anthracite half round grey uPVC guttering and downpipes

External Timber Wall
NB: Timber wall construction from door head to roof eaves only.

Wall Construction consisting of the following from inside to out:
- 2no. 12.5mm plasterboard with skim finish
- 50x25mm timber batten zone
- 100x50mm timber studwork with acoustic APR insulation roll
- 100mm PIR insulation board
- 100x50mm timber studwork with full fill insulation
- 18mm OSB3 sheathing
- 50x25mm vertical timber battens @ 400mm centres
- 50x25mm horizontal timber battens
- 19mm vertical timber cladding to client choice and finish

- To achieve a U-Value of 0.28W/(m².K)2 or better

PPC aluminium sliding doors, two sashes in RAL 7016

ACO threshold drain across the width of the sliding doors to protect the accommodation from any flash flooding, threshold channels to be connected to new soakaway. Soakaway to be positioned 5.0m from any building and 2.0m from any boundaries.

External hard surface treatment to clients requirements, finish to be set to 1:60 falls away from building

Ground Bearing Slab

Floor Construction consisting of the following from inside to out:
- Floor finish to client choice
- 65mm screed (traditional or liquid screed to be discussed)
- Optional UFH within screed to be agreed with client
- 1200 gauge polythene membrane
- 90mm PIR insulation board
- DPM
- 150mm RC Concrete Slab to Structural Engineers design
- Sacrificial DPM to prevent concrete curing too quickly
- 150mm Hardcore to Structural Engineers requirements
- Prepared ground

- To achieve a U-Value of 0.18W/(m².K)2 or better

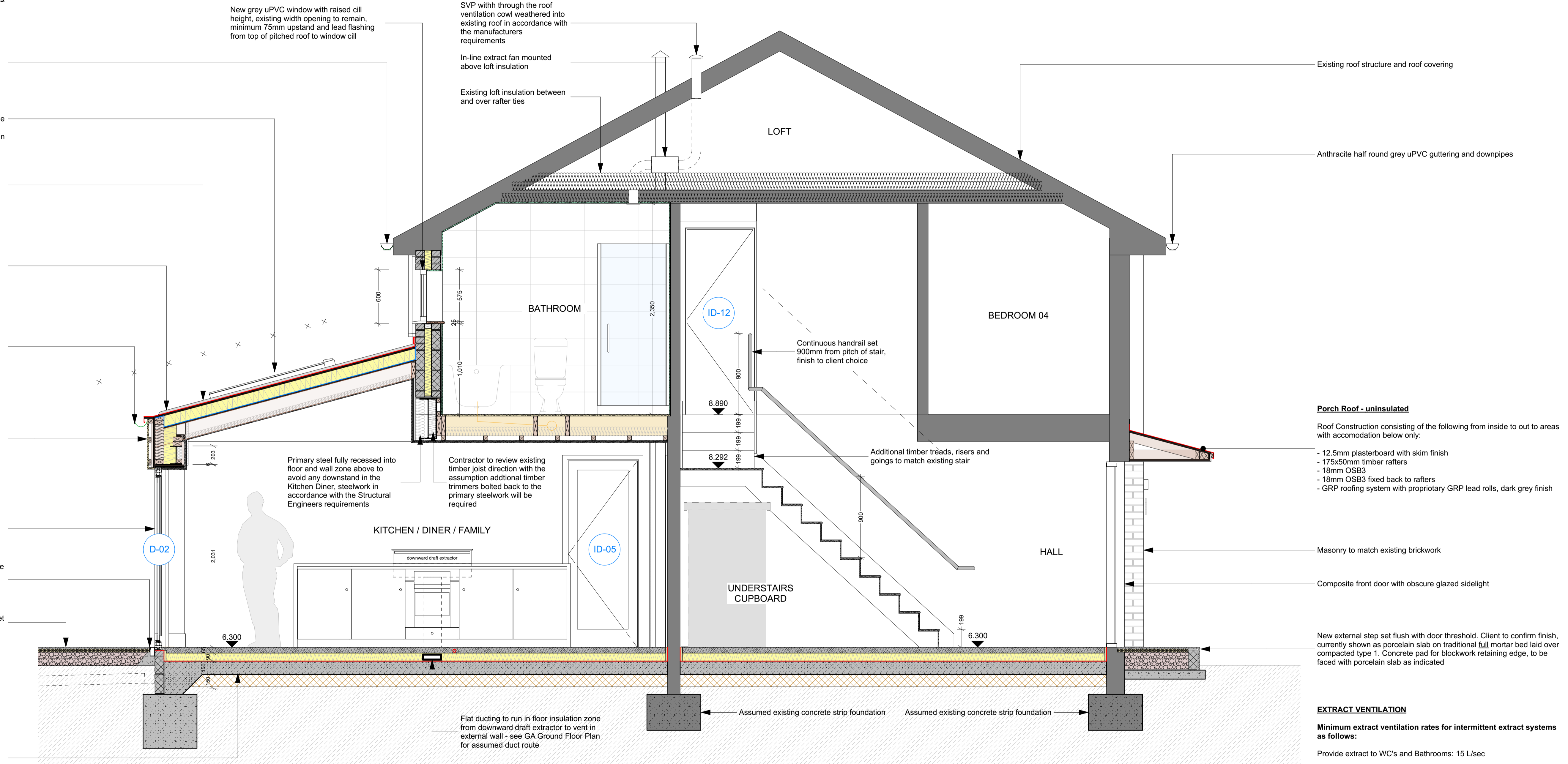

Existing roof structure and roof covering

Anthracite half round grey uPVC guttering and downpipes

Porch Roof - uninsulated
Roof Construction consisting of the following from inside to out to areas with accommodation below only:
- 12.5mm plasterboard with skim finish
- 175x50mm timber rafters
- 18mm OSB3
- 18mm OSB3 fixed back to rafters
- GRP roofing system with proprietary GRP lead rolls, dark grey finish

Masonry to match existing brickwork

Composite front door with obscure glazed sidelight

New external step set flush with door threshold. Client to confirm finish, currently shown as porcelain slab on traditional full mortar bed laid over compacted type 1. Concrete pad for blockwork retaining edge, to be faced with porcelain slab as indicated

EXTRACT VENTILATION
Minimum extract ventilation rates for intermittent extract systems as follows:

- Provide extract to WC's and Bathrooms: 15 L/sec
- Provide extract to Kitchen: 30L/sec (When extracting to the outside)
- Provide extract to Utility Room: 30L/sec
- All ventilation to be in accordance with Building Regulations Part F

rev.	date	changes description	issued by
C02	16/02/2023	Building Control Officer amendments	DF
C01	30/01/2023	Client layout amendments, June 2022 Part L amendments	DF



<p>www.archibuild.uk hello@archibuild.uk t: 02393 812350 m: 07500 662998</p>	<p>drawn by DF</p>	<p>date created 16/02/2023</p>	<p>project title Rowallan Avenue document title Section 02</p>	<p>project 31 Rowallan Avenue suitability description Building Control</p>	<p>number 0402 revision C02</p>
--	------------------------	------------------------------------	--	--	---